

---

COMMUNITY DEVELOPMENT DEPARTMENT

## NOTICE TO THE PUBLIC

December 3, 2021

To Whom It May Concern:

Don Schreiner, on behalf of Rockford Orthopedic Associates Ltd DBA OrthoIllinois/OrthoWisconsin, has filed an application for a Land Management Plan for the property located at **2102 Freeman Parkway** in the City of Beloit. According to Section 2-1200 of the City of Beloit Zoning Ordinance, the owner or those with site control of land one-half acre or more in size may seek approval of a Land Management Plan to allow grasses to exceed eight (8) inches in height.

The applicant has submitted site & architectural plans to construct a 26,571 square-foot medical facility on the subject property. The proposed landscape plan for this development includes areas of native plantings (mix of native grasses/sedges/forbs), primarily around the sides and rear of the property as shown on the attached plan. Electronic copies of the application and Landscape Plan are available upon request from Planning staff.

According to the Zoning Ordinance, property owners in the City within 200 feet of the property on which a Land Management Plan is proposed must be notified of the pending application. If, within 15 days of receipt of this notification and application, less than 51 percent of the adjacent property owners file written objections to this Land Management Plan, Planning staff may approve the plan. If more than 51 percent of those notified file written (hard copy or e-mail) objections to the plan, the Board of Appeals will hold a public hearing and render a final decision. **Any written objections to this Land Management Plan must be received in the Planning & Building Services Division by 5 PM on Monday, December 27, 2021.**

A full copy of the proposed Land Management Plan is available for review in the Planning & Building Services Division at City Hall, located at 100 State Street. If you have any questions, please contact Drew Pennington, AICP, Director of Planning & Building Services, at (608) 364-6711 or [penningtond@beloitwi.gov](mailto:penningtond@beloitwi.gov).



# CITY of BELOIT

## NEIGHBORHOOD PLANNING DIVISION

100 State Street, Beloit, WI 53511

Phone: (608) 364-6700 / Fax: (608) 364-6609

### LAND MANAGEMENT PLAN APPLICATION

(Please Type or Print)

LMP-2021-01

1. Address of property: 2102 Freeman Parkway

2. Legal description: Lot: \_\_\_\_\_ Block: \_\_\_\_\_ Subdivision: Unplatted DP

If property has not been subdivided, attach a copy of the complete legal description.

Total area of property in acres: \_\_\_\_\_

3. Tax Parcel Number(s): 22031650 DBA Ortho IL/WI DP

4. Owner of record: Rockford Orthopedic Associates LTD Phone: 815-484-6915

324 Roxbury Road Rockford IL 61107  
(Address) (City) (State) (Zip)

5. Applicant's Name: Don Schreiner

324 Roxbury Road Rockford IL 61107  
(Address) (City) (State) (Zip)

815-484-6915 / \_\_\_\_\_ / dons@orthoillinois.com  
(Office Phone #) (Cell Phone #) (E-mail Address)

6. All existing use(s) on this property are: Vacant Land

#### 7. THE FOLLOWING LAND MANAGEMENT PLAN IS PROPOSED:

Describe plan here or submit plan on separate attachment along with application.

This is a brief summary of the proposed native plantings for the proposed OrthoWisconsin Project to be located at 2102 Freeman Parkway in Beloit, Wisconsin. The native plantings will consist of two different plant communities a small wet to mesic planting zone in the low portions of the detention basin and a low-profile prairie plant community in and around the detention basin and wrapping around the site. The intention of these native planting areas is to transition from the wet bottom plantings in the detention basin to the low-profile prairie up to the and into the existing and surrounding woodland areas.

The native planting areas will be a mix of native grasses, sedges, and forbs selected for the differing growing conditions on the site. These plantings will be monitored and maintained on a regular basis through seasonal mowing and suppression of invasive species through the use of mechanical and selective spot herbicide applications as needed. The mature native plantings will height of 18" to 36" while in flower. Below are (photos) DP

See attachments for legal description and several examples that convey the intention of the native plantings for this project



8. I/We) represent that I/we have a vested interest in this property in the following manner:

(x) Owner

( ) Leasehold, Length of lease: \_\_\_\_\_

( ) Contractual, Nature of contract: \_\_\_\_\_

( ) Other, Explain: \_\_\_\_\_

The applicant's signature below indicates the information contained in this application and on all accompanying documents is true and correct.

The undersigned does hereby respectfully make application for approval of a Land Management Plan. The undersigned represents that the granting of the proposed request will not violate any of the required standards of any Ordinance of the City of Beloit. The undersigned also agrees to abide by all applicable federal, state and local laws, ordinances, rules, and regulations.

*Don Schreiner* / Don SCHREINER / 12-1-21  
(Signature of owner) (Print name) (Date)

Michael Hurt / Mike Hurt / 12/1/2021  
(Signature of applicant, if different) (Print name) (Date)

**NOTE:** Adjacent property owners may object to the proposed Land Management Plan by filing a written objection with the Neighborhood Planning Division within 15 days of the date of mailing the notices to adjacent property owners. If 51% or more of the adjacent property owners file written objections to the application, the application must be referred to the Board of Appeals for a public hearing and their final decision. Otherwise the Director of Planning may approve or deny the proposed Land Management Plan.

This application must be submitted with one copy of a scaled drawing showing the layout of the property, all adjacent properties, streets and sidewalks and areas and notes related to the proposed Land Management Plan.

#### To be completed by Planning staff

Applicants must reimburse the City for the cost of postage and copies for mailing notices.

Number of notices \_\_\_\_\_ x mailing cost (\$0.50) = cost of mailing notices: \$ \_\_\_\_\_

Application accepted by: *Don Pennington* Date: 12/3/21



**Legal Description:**

PART OF LOT 4, MORGAN FARM, IN PART OF THE NORTHEAST 1/4 OF THE SOUTHWEST 1/4, AND IN PART OF THE NORTHWEST 1/4 OF THE SOUTHEAST 1/4 OF SECTION 20, TOWNSHIP 1 NORTH, RANGE 13 EAST OF THE 4TH P.M., CITY OF BELOIT, COUNTY OF ROCK, STATE OF WISCONSIN, DESCRIBED AS FOLLOWS: BEGINNING AT A POINT IN THE NORTH AND SOUTH CENTERLINE OF SAID SECTION 20, 1654 FEET N. 1° 07' E. FROM THE SOUTH 1/4 CORNER OF SAID SECTION; THENCE S. 57° 42' W. 176.9 FEET TO AN IRON PIPE; THENCE N. 13° 33' W., ALONG THE EAST LINE OF LAND DEEDED TO HIRAM MORGAN, 511 FEET MORE OR LESS TO THE CENTERLINE OF TURTLE CREEK; THENCE NORTHERLY UPSTREAM, ALONG THE CENTERLINE OF TURTLE CREEK, 285 FEET MORE OR LESS; THENCE N. 83° 36' E. 317 FEET MORE OR LESS TO AN IRON PIPE; THENCE S. 61° 15' E. 293.45 FEET TO AN IRON PIPE; THENCE S. 29° 40 2/3' W. 329.2 FEET TO AN IRON PIN; THENCE S. 32° 18' E. 120.26 FEET TO AN IRON PIPE; THENCE S. 57° 42' W. 304.88 FEET TO AN IRON PIPE AT THE PLACE OF BEGINNING.

**Photos:**



*Figure 1 - Low-profile Prairie After 3 Years*



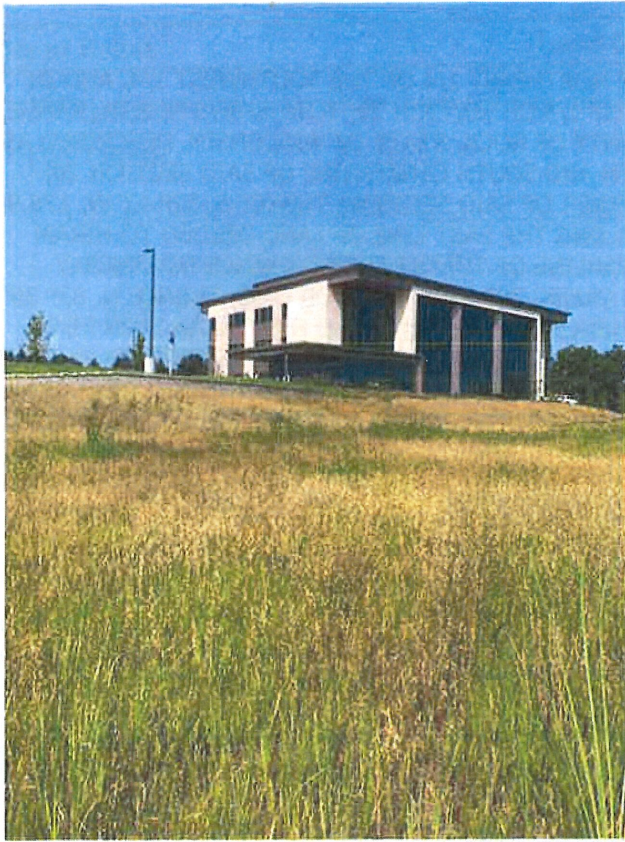

*Figure 2 - Low-profile Prairie After 1 Year*



*Figure 3 - Bio-swale and Wet-bottom Plantings - 2 Years After Installation.*



PLANT SCHEDULE

| CANOPY TREES     | BOTANICAL / COMMON NAME  | COND  | SIZE        | QTY       |
|------------------|--|-------|-------------|-----------|
| ACE STA          | ACER MIYABEI 'STATE STREET' / MIYABEI MAPLE                                    | B & B | 2.5" CAL.   | 4         |
| CEL F23          | ACER X FREEMANII / FREEMAN MAPLE   | B & B | 2.5" CAL.   | 2         |
| CEL OC2          | CELSTIS OCCIDENTALIS / COMMON HACKBERRY  | B & B | 2.5" CAL.   | 6         |
| CEL 119          | CELSTIS TRACANTHOS INERMIS 'SKYLINE' / THORNLESS SKYLINE HONEYLOCUST           | B & B | 2.5" CAL.   | 4         |
| GYM DIO          | GYMNOCLADUS DIOICA 'ESPRESSO' / KENTUCKY COFFEETREE                            | B & B | 2.5" CAL.   | 5         |
| QUE BIC          | QUERCUS BICOLOR / SWAMP WHITE OAK  | B & B | 2.5" CAL.   | 3         |
| TIL RE2          | TILIA AMERICANA 'REDMOND' / REDMOND AMERICAN LINDEN                            | B & B | 2.5" CAL.   | 2         |
| EVERGREEN TREES  | BOTANICAL / COMMON NAME  | COND  | SIZE        | QTY       |
| JUN CUP          | JUNIPERUS VIRGINIANA 'CUPRESSIFOLIA' / HILLSPIRE JUNIPER                       | B & B | 6" HT.      | 14        |
| THU SMA          | THUJA OCCIDENTALIS 'SMARAGO' / EMERALD GREEN ARBORVITAE                        | B & B | 6" HT.      | 5         |
| UNDERSTORY TREES | BOTANICAL / COMMON NAME  | COND  | SIZE        | QTY       |
| AME GRA          | AMELANCHIER X GRANDIFLORA 'AUTUMN BRILLIANCE' / AUTUMN BRILLIANCE SERVICEBERRY | B & B | 8" CLUMP    | 4         |
| BET MH7          | BETULA POPULIFOLIA 'WHITESPIRE' / WHITESPIRE BIRCH                             | B & B | 8" CLUMP    | 4         |
| CER CAN          | CERCIS CANADENSIS / EASTERN REDBUD   | B & B | 8" CLUMP    | 3         |
| SYR VO           | SYRINGA RETICULATA 'IVORY SILK' / IVORY SILK JAPANESE TREE LILAC               | B & B | 2.5" CAL.   | 5         |
| DECIDUOUS SHRUBS | BOTANICAL / COMMON NAME  | COND  | SIZE        | QTY       |
| ARO RED          | ARONIA ARBUTIFOLIA / RED CHOKEBERRY  | B & B | 30" HT.     | 7         |
| COT ACU          | COTONEASTER ACUTIFOLIUS / PEKING COTONEASTER                                   | B & B | 36" HT.     | 15        |
| FOT AIR          | FOTHERGILLA GARDENII 'MT. AIRY' / MOUNT AIRY FOTHERGILLIA                      | B & B | 24" HT.     | 21        |
| HYD LIM          | HYDRANGEA PANICULATA 'LIMELIGHT' / LIMELIGHT HYDRANGEA                         | B & B | 24" HT.     | 13        |
| PHY NIN          | PHYSCARPUS OPULOFOLIUS 'SUMMER WINE' / SUMMER WINE NINEBARK                    | B & B | 36" HT.     | 3         |
| RHU ARO          | RHUS AROMATICA 'ORO-LOW' / ORO-LOW FRAGRANT SUMAC                              | B & B | 24" HT.     | 3         |
| RIB GRE          | RIBES ALPIMUM 'GREEN MOUND' / GREEN MOUND ALPINE CURRANT                       | B & B | 24" HT.     | 5         |
| ROS FL3          | ROSA X 'FLOWER CARPET CORAL' / ROSE  | 5 GAL | 24" SPREAD. | 62        |
| SYR MEY          | SYRINGA MEYERI 'PALIBIN' / DWARF KOREAN LILAC                                  | B & B | 30" HT.     | 14        |
| VIB BLA          | VIBURNUM PRUNIFOLIUM / BLACKHAW VIBURNUM                                       | B & B | 36" HT.     | 37        |
| EVERGREEN SHRUBS | BOTANICAL / COMMON NAME  | COND  | SIZE        | QTY       |
| JUN FOR          | JUNIPERUS CHINENSIS 'SEA GREEN' / SEA GREEN JUNIPER                            | B & B | 24" SPREAD. | 11        |
| JUN HUG          | JUNIPERUS HORIZONTALIS 'HUGHES' / HUGHES JUNIPER                               | B & B | 24" SPREAD. | 54        |
| TAX DEN          | TAXUS X MEDIA 'DENSIFORMIS' / DENSE YEW  | B & B | 30" HT.     | 46        |
| GRASSES          | BOTANICAL / COMMON NAME  | COND  | SIZE        | QTY       |
| CAL KAR          | CALAMAGROSTIS X ACUTIFLORA 'KARL FOERSTER' / FEATHER REED GRASS                | CONT. | #1          | 41        |
| CAR SED          | CAREX PENNSYLVANICA / PENNSYLVANIA SEDGE                                       | CONT. | #1          | 22        |
| DES PIX          | DESCHAMPSIA CESPIOSA 'PIXIE FOUNTAIN' / PIXIE FOUNTAIN TUFTED HAIR GRASS       | CONT. | #1          | 22        |
| PAN VIT          | PANICUM VIRGATUM 'HEAVY METAL' / BLUE SWITCH GRASS                             | CONT. | #1          | 40        |
| SPO HET          | SPOROBOLUS HETEROLEPSIS / PRAIRIE DROPSSEED                                    | CONT. | #1          | 116       |
| GROUND COVERS    | BOTANICAL / COMMON NAME  | COND  | SIZE        | QTY       |
| ECH MAG          | ECHINACEA PURPUREA 'MAGNUS' / MAGNUS PURPLE CONEFLOWER                         | CONT. | QUART       | 54        |
| GA AR1           | GAillardia X 'ARIZONA SUN' / BLANKET FLOWER                                    | CONT. | #1          | 99        |
| GEU TRI          | GEUM TRIFLORUM / PRAIRIE SMOKE   | CONT. | QUART       | 109       |
| HEM OR2          | HEMEROCALLIS X 'STELLA DE ORO' / STELLA DE ORO DAYLILY                         | CONT. | #1          | 184       |
| HOS LIB          | HOSTA X 'LIBERTY' / PLANTAIN LILY  | CONT. | #1          | 32        |
| LEU DA2          | LEUCANTHEMUM X SUPERBUM 'DAISY MAY' / SHASTA DAISY                             | CONT. | QUART       | 11        |
| LIR CRE          | LIRIOPE SPICATA / CREEPING LILY TURF   | CONT. | QUART       | 448       |
| MON PET          | MONARDA DIDYMA 'PETITE DELIGHT' / PETITE DELIGHT BEE BALM                      | CONT. | QUART       | 51        |
| MON BER          | MONARDA PISTHOSA / BEGONIA   | CONT. | #1          | 24        |
| NEP WAL          | NEPETA X FASSENII 'WALKERS LOW' / WALKERS LOW CATMINT                          | CONT. | QUART       | 405       |
| RAC BRO          | RACHYSTERNA PRODIGIOSA / RACHYSTERNA SURGE                                     | CONT. | QUART       | 42        |
| RUD GL2          | RUDBECKIA FULGIDA 'GLODSTRUM' / BLACK-EYED SUSAN                               | CONT. | QUART       | 153       |
| SYM PUS          | SYMPHYOTRICHUM NOVAE-ANGLIAE 'PURPLE DOME' / NEW ENGLAND ASTER                 | CONT. | #1          | 66        |
| TURF GRASS       | BOTANICAL / COMMON NAME  | COND  | SIZE        | QTY       |
| TUR DRO          | TURF SEED / DROUGHT TOLERANT TURF BLEND  | SEED  | S.F.        | 52,230 SF |

SITE MATERIALS SCHEDULE

|                         |           |           |
|-------------------------|-----------|-----------|
| BIO-SWALE PLANTINGS     | 7,419 SF  |           |
| LOW-PROFILE PRAIRIE     | 42,189 SF | -4,699 SF |
| MULCH                   | 27,168 SF | -192 SF   |
| PAVERS                  | 963 SF    |           |
| WET-BOTTOM NATIVE PLUGS | 1,254 SF  |           |

BIO-SWALE NATIVE PLUG PLANTING LIST:

| Botanical Name                       | Common Name                  | Quantity | Size      | Spacing  |
|--------------------------------------|------------------------------|----------|-----------|----------|
| Asclepias incarnata                  | Marsh Milkweed               | 128      | 2.5" Plug | 18" o.c. |
| Asclepias tuberosa                   | New England Aster            | 128      | 2.5" Plug | 18" o.c. |
| Asclepias tuberosa                   | Swamp Aster                  | 128      | 2.5" Plug | 18" o.c. |
| Asclepias tuberosa                   | Pale Purple Coneflower       | 128      | 2.5" Plug | 18" o.c. |
| Asclepias tuberosa                   | Purple Coneflower            | 128      | 2.5" Plug | 18" o.c. |
| Asclepias tuberosa                   | Big Leafed Aster             | 128      | 2.5" Plug | 18" o.c. |
| Asclepias tuberosa                   | Prairie Blazing Star         | 128      | 2.5" Plug | 18" o.c. |
| Asclepias tuberosa                   | Wild Bergamot                | 128      | 2.5" Plug | 18" o.c. |
| Asclepias tuberosa                   | Mountain Mint                | 128      | 2.5" Plug | 18" o.c. |
| Asclepias tuberosa                   | Orange Coneflower            | 128      | 2.5" Plug | 18" o.c. |
| Asclepias tuberosa                   | Black-eyed Susan             | 128      | 2.5" Plug | 18" o.c. |
| Asclepias tuberosa                   | Spiranthes                   | 128      | 2.5" Plug | 18" o.c. |
| Asclepias tuberosa                   | Blue Vervain                 | 128      | 2.5" Plug | 18" o.c. |
| Asclepias tuberosa                   | Golden Alexander             | 128      | 2.5" Plug | 18" o.c. |
| SUBTOTAL                             |                              | 1280     |           |          |
| GRASSES OR GRASS-LIKE PERENNIALS 40% |                              |          |           |          |
| Carex bicknellii                     | Copper Shouldered Oval Sedge | 224      | 2.5" Plug | 18" o.c. |
| Carex brenovii                       | Plains Oval Sedge            | 224      | 2.5" Plug | 18" o.c. |
| Carex frankii                        | Brushtail Grass              | 224      | 2.5" Plug | 18" o.c. |
| Carex frankii                        | Creeping Spike Rush          | 224      | 2.5" Plug | 18" o.c. |
| Carex frankii                        | Creeping Spike Rush          | 224      | 2.5" Plug | 18" o.c. |
| Carex frankii                        | Creeping Spike Rush          | 224      | 2.5" Plug | 18" o.c. |
| Carex frankii                        | Creeping Spike Rush          | 224      | 2.5" Plug | 18" o.c. |
| Carex frankii                        | Creeping Spike Rush          | 224      | 2.5" Plug | 18" o.c. |
| Carex frankii                        | Creeping Spike Rush          | 224      | 2.5" Plug | 18" o.c. |
| Carex frankii                        | Creeping Spike Rush          | 224      | 2.5" Plug | 18" o.c. |
| SUBTOTAL                             |                              | 2240     |           |          |
| TOTAL PLANTS                         |                              | 3520     |           |          |

LOW-PROFILE PRAIRIE SEED MIX:

| Botanical Name                       | Common Name                  | P.L.S. Ounces/Acre |
|--------------------------------------|------------------------------|--------------------|
| Asclepias incarnata                  | Marsh Milkweed               | 10.00              |
| Asclepias tuberosa                   | New England Aster            | 10.00              |
| Asclepias tuberosa                   | Swamp Aster                  | 10.00              |
| Asclepias tuberosa                   | Pale Purple Coneflower       | 10.00              |
| Asclepias tuberosa                   | Purple Coneflower            | 10.00              |
| Asclepias tuberosa                   | Big Leafed Aster             | 10.00              |
| Asclepias tuberosa                   | Prairie Blazing Star         | 10.00              |
| Asclepias tuberosa                   | Wild Bergamot                | 10.00              |
| Asclepias tuberosa                   | Mountain Mint                | 10.00              |
| Asclepias tuberosa                   | Orange Coneflower            | 10.00              |
| Asclepias tuberosa                   | Black-eyed Susan             | 10.00              |
| Asclepias tuberosa                   | Spiranthes                   | 10.00              |
| Asclepias tuberosa                   | Blue Vervain                 | 10.00              |
| Asclepias tuberosa                   | Golden Alexander             | 10.00              |
| SUBTOTAL                             |                              | 100.00             |
| GRASSES OR GRASS-LIKE PERENNIALS 40% |                              |                    |
| Carex bicknellii                     | Copper Shouldered Oval Sedge | 10.00              |
| Carex brenovii                       | Plains Oval Sedge            | 10.00              |
| Carex frankii                        | Brushtail Grass              | 10.00              |
| Carex frankii                        | Creeping Spike Rush          | 10.00              |
| Carex frankii                        | Creeping Spike Rush          | 10.00              |
| Carex frankii                        | Creeping Spike Rush          | 10.00              |
| Carex frankii                        | Creeping Spike Rush          | 10.00              |
| Carex frankii                        | Creeping Spike Rush          | 10.00              |
| Carex frankii                        | Creeping Spike Rush          | 10.00              |
| Carex frankii                        | Creeping Spike Rush          | 10.00              |
| Carex frankii                        | Creeping Spike Rush          | 10.00              |
| SUBTOTAL                             |                              | 100.00             |
| TOTAL PLANTS                         |                              | 200.00             |

WET-BOTTOM NATIVE PLUG PLANTING LIST:

| Botanical Name                              | Common Name                  | Quantity        | Size       | Spacing  |
|---|------------------------------|-----------------|------------|----------|
| <b>PERENNIALS 40%</b>                       |                              |                 |            |          |
| Asclepias incarnata                         | Marsh Milkweed               | 48              | 2.5" Plug  | 18" o.c. |
| Aster novae-angliae                         | New England Aster            | 32              | 2.5" Plug  | 18" o.c. |
| Asclepias tuberosa                          | Swamp Aster                  | 48              | 2.5" Plug  | 18" o.c. |
| Asclepias tuberosa                          | Big Leafed Aster             | 32              | 2.5" Plug  | 18" o.c. |
| Asclepias tuberosa                          | Orange Coneflower            | 48              | 2.5" Plug  | 18" o.c. |
| Asclepias tuberosa                          | Wild Bergamot                | 32              | 2.5" Plug  | 18" o.c. |
| Asclepias tuberosa                          | Purple Coneflower            | 48              | 2.5" Plug  | 18" o.c. |
| Asclepias tuberosa                          | Black-eyed Susan             | 48              | 2.5" Plug  | 18" o.c. |
| Asclepias tuberosa                          | Spiranthes                   | 48              | 2.5" Plug  | 18" o.c. |
| Verbena hastata                             | Blue Vervain                 | 48              | 2.5" Plug  | 18" o.c. |
|   |                              | <b>SUBTOTAL</b> | <b>480</b> |          |
| <b>GRASSES OR GRASS-LIKE PERENNIALS 40%</b> |                              |                 |            |          |
| Carex brenovii                              | Copper Shouldered Oval Sedge | 32              |            |          |
| Carex frankii                               | Plains Oval Sedge            | 32              | 2.5" Plug  | 18" o.c. |
| Carex frankii                               | Brushtail Grass              | 48              | 2.5" Plug  | 18" o.c. |
| Carex lasiocarpa                            | Brown Fox Grass              | 48              | 2.5" Plug  | 18" o.c. |
| Carex lasiocarpa                            | Creeping Spike Rush          | 32              | 2.5" Plug  | 18" o.c. |
| Carex lasiocarpa                            | Creeping Spike Rush          | 32              | 2.5" Plug  | 18" o.c. |
| Carex lasiocarpa                            | Creeping Spike Rush          | 48              | 2.5" Plug  | 18" o.c. |
| Carex lasiocarpa                            | Creeping Spike Rush          | 48              | 2.5" Plug  | 18" o.c. |
| Carex lasiocarpa                            | Creeping Spike Rush          | 48              | 2.5" Plug  | 18" o.c. |
| Carex lasiocarpa                            | Creeping Spike Rush          | 48              | 2.5" Plug  | 18" o.c. |
| Carex lasiocarpa                            | Creeping Spike Rush          | 48              | 2.5" Plug  | 18" o.c. |
| Carex lasiocarpa                            | Creeping Spike Rush          | 48              | 2.5" Plug  | 18" o.c. |
| Carex lasiocarpa                            | Creeping Spike Rush          | 48              | 2.5" Plug  | 18" o.c. |
| Carex lasiocarpa                            | Creeping Spike Rush          | 48              | 2.5" Plug  | 18" o.c. |
| Carex lasiocarpa                            | Creeping Spike Rush          | 48              | 2.5" Plug  | 18" o.c. |
| Carex lasiocarpa                            | Creeping Spike Rush          | 48              | 2.5" Plug  | 18" o.c. |
| Carex lasiocarpa                            | Creeping Spike Rush          | 48              | 2.5" Plug  | 18" o.c. |
| Carex lasiocarpa                            | Creeping Spike Rush          | 48              | 2.5" Plug  | 18" o.c. |
| Carex lasiocarpa                            | Creeping Spike Rush          | 48              | 2.5" Plug  | 18" o.c. |
| Carex lasiocarpa                            | Creeping Spike Rush          | 48              | 2.5" Plug  | 18" o.c. |
| Carex lasiocarpa                            | Creeping Spike Rush          | 48              | 2.5" Plug  | 18" o.c. |
| Carex lasiocarpa                            | Creeping Spike Rush          | 48              | 2.5" Plug  | 18" o.c. |
| Carex lasiocarpa                            | Creeping Spike Rush          | 48              | 2.5" Plug  | 18" o.c. |
| Carex lasiocarpa                            | Creeping Spike Rush          | 48              | 2.5" Plug  | 18" o.c. |
| Carex lasiocarpa                            | Creeping Spike Rush          | 48              | 2.5" Plug  | 18" o.c. |
| Carex lasiocarpa                            | Creeping Spike Rush          | 48              | 2.5" Plug  | 18" o.c. |
| Carex lasiocarpa                            | Creeping Spike Rush          | 48              | 2.5" Plug  | 18" o.c. |
| Carex lasiocarpa                            | Creeping Spike Rush          | 48              | 2.5" Plug  | 18" o.c. |
| Carex lasiocarpa                            | Creeping Spike Rush          | 48              | 2.5" Plug  | 18" o.c. |
| Carex lasiocarpa                            | Creeping Spike Rush          | 48              | 2.5" Plug  | 18" o.c. |
| Carex lasiocarpa                            | Creeping Spike Rush          | 48              | 2.5" Plug  | 18" o.c. |
| Carex lasiocarpa                            | Creeping Spike Rush          | 48              | 2.5" Plug  | 18" o.c. |
| Carex lasiocarpa                            | Creeping Spike Rush          | 48              | 2.5" Plug  | 18" o.c. |
| Carex lasiocarpa                            | Creeping Spike Rush          | 48              | 2.5" Plug  | 18" o.c. |
| Carex lasiocarpa                            | Creeping Spike Rush          | 48              | 2.5" Plug  | 18" o.c. |
| Carex lasiocarpa                            | Creeping Spike Rush          | 48              | 2.5" Plug  | 18" o.c. |
| Carex lasiocarpa                            | Creeping Spike Rush          | 48              | 2.5" Plug  | 18" o.c. |
| Carex lasiocarpa                            | Creeping Spike Rush          | 48              | 2.5" Plug  | 18" o.c. |
| Carex lasiocarpa                            | Creeping Spike Rush          | 48              | 2.5" Plug  | 18" o.c. |
| Carex lasiocarpa                            | Creeping Spike Rush          | 48              | 2.5" Plug  | 18" o.c. |
| Carex lasiocarpa                            | Creeping Spike Rush          | 48              | 2.5" Plug  | 18" o.c. |
| Carex lasiocarpa                            | Creeping Spike Rush          | 48              | 2.5" Plug  | 18" o.c. |
| Carex lasiocarpa                            | Creeping Spike Rush          | 48              | 2.5" Plug  | 18" o.c. |
| Carex lasiocarpa                            | Creeping Spike Rush          | 48              | 2.5" Plug  | 18" o.c. |
| Carex lasiocarpa                            | Creeping Spike Rush          | 48              | 2.5" Plug  | 18" o.c. |
| Carex lasiocarpa                            | Creeping Spike Rush          | 48              | 2.5" Plug  | 18" o.c. |
| Carex lasiocarpa                            | Creeping Spike Rush          | 48              | 2.5" Plug  | 18" o.c. |
| Carex lasiocarpa                            | Creeping Spike Rush          | 48              | 2.5" Plug  | 18" o.c. |
| Carex lasiocarpa                            | Creeping Spike Rush          | 48              | 2.5" Plug  | 18" o.c. |
| Carex lasiocarpa                            | Creeping Spike Rush          | 48              | 2.5" Plug  | 18" o.c. |
| Carex lasiocarpa                            | Creeping Spike Rush          | 48              | 2.5" Plug  | 18" o.c. |
| Carex lasiocarpa                            | Creeping Spike Rush          | 48              | 2.5" Plug  | 18" o.c. |
| Carex lasiocarpa                            | Creeping Spike Rush          | 48              | 2.5" Plug  | 18" o.c. |
| Carex lasiocarpa                            | Creeping Spike Rush          | 48              | 2.5" Plug  | 18" o.c. |
| Carex lasiocarpa                            | Creeping Spike Rush          | 48              | 2.5" Plug  | 18" o.c. |
| Carex lasiocarpa                            | Creeping Spike Rush          | 48              | 2.5" Plug  | 18" o.c. |
| Carex lasiocarpa                            | Creeping Spike Rush          | 48              | 2.5" Plug  | 18" o.c. |
| Carex lasiocarpa                            | Creeping Spike Rush          | 48              | 2.5" Plug  | 18" o.c. |
| Carex lasiocarpa                            | Creeping Spike Rush          | 48              | 2.5" Plug  | 18" o.c. |
| Carex lasiocarpa                            | Creeping Spike Rush          | 48              | 2.5" Plug  | 18" o.c. |
| Carex lasiocarpa                            | Creeping Spike Rush          | 48              | 2.5" Plug  | 18" o.c. |
| Carex lasiocarpa                            | Creeping Spike Rush          | 48              | 2.5" Plug  | 18" o.c. |
| Carex lasiocarpa                            | Creeping Spike Rush          | 48              | 2.5" Plug  | 18" o.c. |
| Carex lasiocarpa                            | Creeping Spike Rush          | 48              | 2.5" Plug  | 18" o.c. |
| Carex lasiocarpa                            | Creeping Spike Rush          | 48              | 2.5" Plug  | 18" o.c. |
| Carex lasiocarpa                            | Creeping Spike Rush          | 48              | 2.5" Plug  | 18" o.c. |
| Carex lasiocarpa                            | Creeping Spike Rush          | 48              | 2.5" Plug  | 18" o.c. |
| Carex lasiocarpa                            | Creeping Spike Rush          | 48              | 2.5" Plug  | 18" o.c. |
| Carex lasiocarpa                            | Creeping Spike Rush          | 48              | 2.5" Plug  | 18" o.c. |
| Carex lasiocarpa                            | Creeping Spike Rush          | 48              | 2.5" Plug  | 18" o.c. |
| Carex lasiocarpa                            | Creeping Spike Rush          | 48              | 2.5" Plug  | 18" o.c. |
| Carex lasiocarpa                            | Creeping Spike Rush          | 48              | 2.5" Plug  | 18" o.c. |
| Carex lasiocarpa                            | Creeping Spike Rush          | 48              | 2.5" Plug  | 18" o.c. |
| Carex lasiocarpa                            | Creeping Spike Rush          | 48              | 2.5" Plug  | 18" o.c. |
| Carex lasiocarpa                            | Creeping Spike Rush          | 48              | 2.5" Plug  | 18" o.c. |
| Carex lasiocarpa                            | Creeping Spike Rush          | 48              | 2.5" Plug  | 18" o.c. |
| Carex lasiocarpa                            | Creeping Spike Rush          | 48              | 2.5" Plug  | 18" o.c. |
| Carex lasiocarpa                            | Creeping Spike Rush          | 48              | 2.5" Plug  | 18" o.c. |
| Carex lasiocarpa                            | Creeping Spike Rush          | 48              | 2.5" Plug  | 18" o.c. |
| Carex lasiocarpa                            | Creeping Spike Rush          | 48              | 2.5" Plug  | 18" o.c. |
| Carex lasiocarpa                            | Creeping Spike Rush          | 48              | 2.5" Plug  | 18" o.c. |
| Carex lasiocarpa                            | Creeping Spike Rush          | 48              | 2.5" Plug  | 18" o.c. |
| Carex lasiocarpa                            | Creeping Spike Rush          | 48              | 2.5" Plug  | 18" o.c. |
| Carex lasiocarpa                            | Creeping Spike Rush          | 48              | 2.5" Plug  | 18" o.c. |
| Carex lasiocarpa                            | Creeping Spike Rush          | 48              | 2.5" Plug  | 18" o.c. |
| Carex lasiocarpa                            | Creeping Spike Rush          | 48              | 2.5" Plug  | 18" o.c. |
| Carex lasiocarpa                            | Creeping Spike Rush          | 48              | 2.5" Plug  | 18" o.c. |
| Carex lasiocarpa                            | Creeping Spike Rush          | 48              | 2.5" Plug  | 18" o.c. |
| Carex lasiocarpa                            | Creeping Spike Rush          | 48              | 2.5" Plug  | 18" o.c. |
| Carex lasiocarpa                            | Creeping Spike Rush          | 48              | 2.5" Plug  | 18" o.c. |
| Carex lasiocarpa                            | Creeping Spike Rush          | 48              | 2.5" Plug  | 18" o.c. |
| Carex lasiocarpa                            | Creeping Spike Rush          | 48              | 2.5" Plug  | 18" o.c. |
| Carex lasiocarpa                            | Creeping Spike Rush          | 48              | 2.5" Plug  | 18" o.c. |
| Carex lasiocarpa                            | Creeping Spike Rush          | 48              | 2.5" Plug  | 18" o.c. |
| Carex lasiocarpa                            | Creeping Spike Rush          | 48              | 2.5" Plug  | 18" o.c. |
| Carex lasiocarpa                            | Creeping Spike Rush          | 48              | 2.5" Plug  | 18" o.c. |
| Carex lasiocarpa                            | Creeping Spike Rush          | 48              | 2.5" Plug  | 18" o.c. |
| Carex lasiocarpa                            | Creeping Spike Rush          | 48              | 2.5" Plug  | 18" o.c. |
| Carex lasiocarpa                            | Creeping Spike Rush          | 48              | 2.5" Plug  | 18" o.c. |
| Carex lasiocarpa                            | Creeping Spike Rush          | 48              | 2.5" Plug  | 18" o.c. |
| Carex lasiocarpa                            | Creeping Spike Rush          | 48              | 2.5" Plug  | 18" o.c. |
| Carex lasiocarpa                            | Creeping Spike Rush          |                 |            |          |

C:\Local Mod\20-0865\20-0865-00-LOCAL\_souper-2021\_06\_18.mxd

1/24/2021 9:43:52 AM