



CITY HALL • 100 STATE STREET • BELOIT, WI 53511  
Office: 608/364-6700 • Fax: 608/364-6609  
www.beloitwi.gov  
*Equal Opportunity Employer*

## **NOTICE TO THE PUBLIC**

January 4, 2023

To Whom It May Concern:

Angus-Young Architects, on behalf of Hendricks Commercial Properties, has filed an application for review and consideration of a Planned Unit Development (PUD) - Master Land Use Plan for the property located at **625 Third Street**. A copy of the PUD - Master Land Use Plan is attached. The applicant has also submitted an application to rezone a portion of the subject property from M-2, General Manufacturing to PUD.

This request is related to a proposed entertainment-oriented use with sales, possession, consumption of liquor, outdoor seating and a rooftop sign. The following public meetings will be held regarding this proposed amendment:

**City Plan Commission:** Wednesday, January 18, 2023, at 7:00 PM, or as soon thereafter as the matter can be heard in The Forum, Beloit City Hall, 100 State Street.

**City Council:** Monday, February 20, 2023, at 7:00 PM, or as soon thereafter as the matter can be heard in The Forum, Beloit City Hall, 100 State Street.

**We are interested in your opinion.**

**Anyone bringing handouts to the Plan Commission meeting must bring 10 copies and submit them to City staff before the meeting begins.**

You may also mail your comments to the attention of Hilary Rottmann at 100 State Street or via email to [planning@beloitwi.gov](mailto:planning@beloitwi.gov). You may also call (608) 364-6708 to provide your comments over the phone.

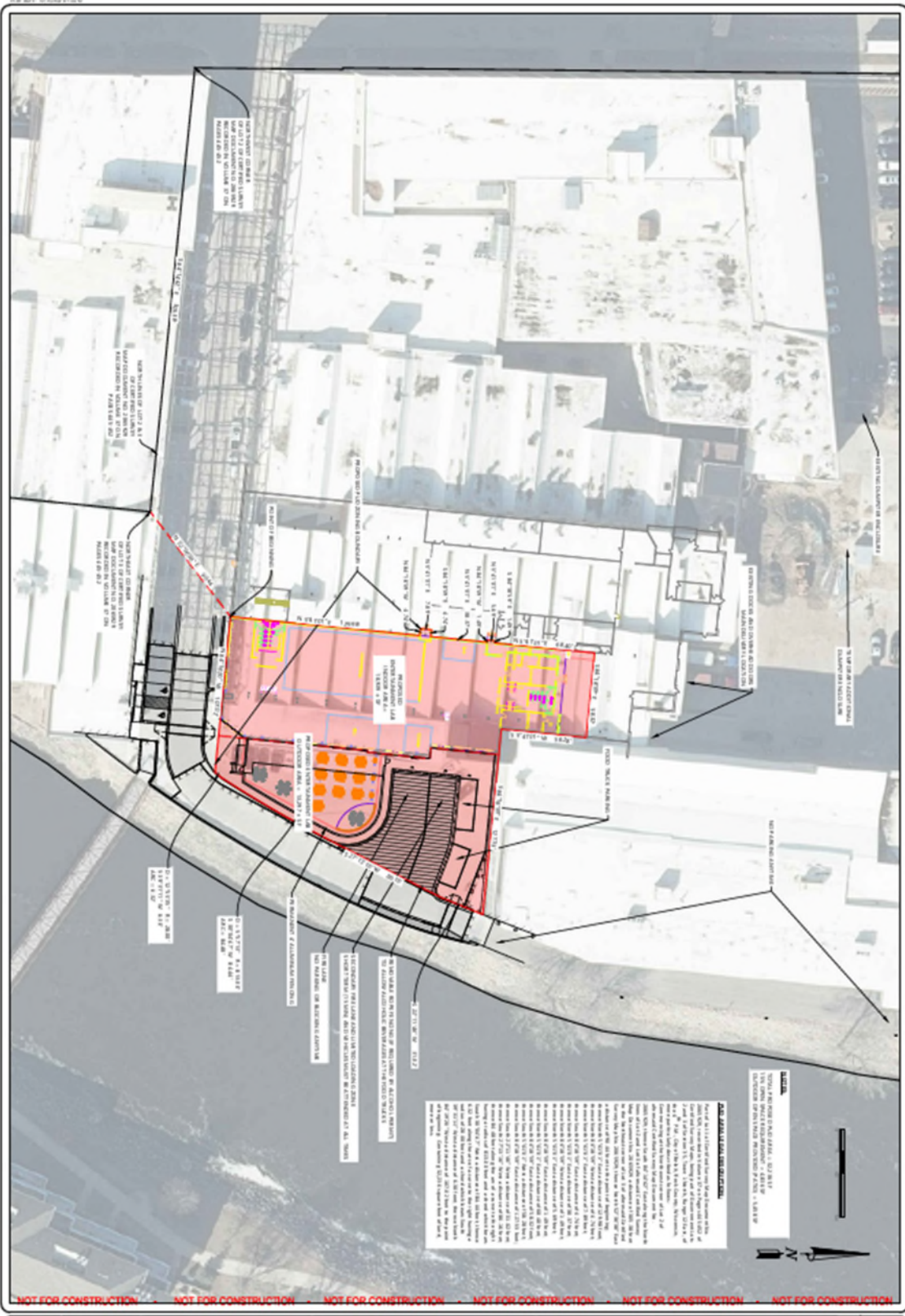

FOR THE EXISTING  
NO. 10. REVISION TO EXISTING  
REVISION TO EXISTING  
REVISION TO EXISTING  
REVISION TO EXISTING

FOR THE EXISTING  
NO. 10. REVISION TO EXISTING  
REVISION TO EXISTING  
REVISION TO EXISTING  
REVISION TO EXISTING

FOR THE EXISTING  
NO. 10. REVISION TO EXISTING  
REVISION TO EXISTING  
REVISION TO EXISTING  
REVISION TO EXISTING

FOR THE EXISTING  
NO. 10. REVISION TO EXISTING  
REVISION TO EXISTING  
REVISION TO EXISTING  
REVISION TO EXISTING

FOR THE EXISTING  
NO. 10. REVISION TO EXISTING  
REVISION TO EXISTING  
REVISION TO EXISTING  
REVISION TO EXISTING

FOR THE EXISTING  
NO. 10. REVISION TO EXISTING  
REVISION TO EXISTING  
REVISION TO EXISTING  
REVISION TO EXISTING

FOR THE EXISTING  
NO. 10. REVISION TO EXISTING  
REVISION TO EXISTING  
REVISION TO EXISTING  
REVISION TO EXISTING

**NOT FOR CONSTRUCTION**

THIS DRAWING IS A PRELIMINARY DESIGN AND IS NOT TO BE USED FOR CONSTRUCTION. IT IS THE PROPERTY OF THE ARCHITECT AND IS NOT TO BE REPRODUCED OR TRANSMITTED IN ANY FORM OR BY ANY MEANS, ELECTRONIC OR MECHANICAL, INCLUDING PHOTOCOPYING, RECORDING, OR BY ANY INFORMATION STORAGE AND RETRIEVAL SYSTEM, WITHOUT THE WRITTEN PERMISSION OF THE ARCHITECT. THE ARCHITECT ASSUMES NO LIABILITY FOR ANY ERRORS OR OMISSIONS IN THIS DRAWING. THE USER OF THIS DRAWING SHALL BE RESPONSIBLE FOR OBTAINING ALL NECESSARY PERMITS AND APPROVALS FROM THE APPROPRIATE AGENCIES. THE ARCHITECT'S RESPONSIBILITY IS LIMITED TO THE DESIGN AND CONSTRUCTION OF THE PROJECT AS SHOWN ON THIS DRAWING. THE ARCHITECT DOES NOT WARRANT THE ACCURACY OF ANY INFORMATION PROVIDED BY OTHERS. THE ARCHITECT'S DESIGN IS BASED ON THE INFORMATION PROVIDED BY THE CLIENT AND THE USER OF THIS DRAWING. THE ARCHITECT DOES NOT WARRANT THE ACCURACY OF ANY INFORMATION PROVIDED BY OTHERS. THE ARCHITECT'S DESIGN IS BASED ON THE INFORMATION PROVIDED BY THE CLIENT AND THE USER OF THIS DRAWING.

**NOT FOR CONSTRUCTION**

THIS DRAWING IS A PRELIMINARY DESIGN AND IS NOT TO BE USED FOR CONSTRUCTION. IT IS THE PROPERTY OF THE ARCHITECT AND IS NOT TO BE REPRODUCED OR TRANSMITTED IN ANY FORM OR BY ANY MEANS, ELECTRONIC OR MECHANICAL, INCLUDING PHOTOCOPYING, RECORDING, OR BY ANY INFORMATION STORAGE AND RETRIEVAL SYSTEM, WITHOUT THE WRITTEN PERMISSION OF THE ARCHITECT. THE ARCHITECT ASSUMES NO LIABILITY FOR ANY ERRORS OR OMISSIONS IN THIS DRAWING. THE USER OF THIS DRAWING SHALL BE RESPONSIBLE FOR OBTAINING ALL NECESSARY PERMITS AND APPROVALS FROM THE APPROPRIATE AGENCIES. THE ARCHITECT'S RESPONSIBILITY IS LIMITED TO THE DESIGN AND CONSTRUCTION OF THE PROJECT AS SHOWN ON THIS DRAWING. THE ARCHITECT DOES NOT WARRANT THE ACCURACY OF ANY INFORMATION PROVIDED BY OTHERS. THE ARCHITECT'S DESIGN IS BASED ON THE INFORMATION PROVIDED BY THE CLIENT AND THE USER OF THIS DRAWING. THE ARCHITECT DOES NOT WARRANT THE ACCURACY OF ANY INFORMATION PROVIDED BY OTHERS. THE ARCHITECT'S DESIGN IS BASED ON THE INFORMATION PROVIDED BY THE CLIENT AND THE USER OF THIS DRAWING.

NOT FOR CONSTRUCTION NOT FOR CONSTRUCTION NOT FOR CONSTRUCTION NOT FOR CONSTRUCTION NOT FOR CONSTRUCTION NOT FOR CONSTRUCTION

